

ITR414-001 - CONVENTIONAL WALL MOUNT MOTION SENSOR



Device	ITR414-001
Power Supply	220-240 V AC, 50/60 Hz
Lux Adjustment	5 Lux to ∞
Detection Range	360°circular, ϕ8m (install height 2.5m)
Type of Protection	IP 40
Temperature Range	Operation (-10°C...50°C)
Maximum Air Humidity	< 90 RH
Flammability	Non-flammable Product
Color	Light Grey and White
Dimensions	115x40 (ΦxH)
Cable Connection	1 x 2.5 mm ² for each terminal
Configuration	Manually

DESCRIPTION

ITR414-001 - Conventional wall mount motion sensor is a functional passive infrared detector. ITR414-001 has 360° sight angle and switching on the lighting according to ambient light level when the sensor detects movement. If there is no movement detected and the pre-set time is elapsed, the lighting will be switched off automatically. With adjustment knob Lux and Time settings can be presetted to make an energy saving and automatic control the lighting. ITR414-001 can be used at proper location in living areas such as home, office, hotel, residence, parking area, corridor etc.

FUNCTIONS & FEATURES

- ITR414-001 contains built-in photocell to make automatic operations at twilight and it is disabled at daylight.
- **Lighting Channel:** Incandescent Lamp; max. 1200W, AC Halogen Lamp; max.800W, LV Halogen Lamp; max 250W, Fluorescent Lamp; max 200W (electronic), LED Lamp (driver); max.200W, Energy Saving Lamp; max 180W (CFL and PL lamp).
CFL : Compact fluorescent lamp. PL : Plug-in fluorescent lamp.
- Adjustable from approximately 5 Lux to ∞ .
- Auto Off Time Adjustment: Adjustable from approximately 5 sec to 12 min and test.
- The sensor lens shield for detection angle adjustment.
- A red LED is equipped as an indicator for test triggering and a green LED is for indicating ETS installation. Moreover, the LED function can be disabled by ETS.
- ITR414-001 supports walk test function to specify the requested field is covered.

IMPORTANT NOTES

- Cable Connections: Ensure making correct connections for Black and Red wires.
- Voltage: The input voltage shall be 21-30VDC.
- Mounting Location: Installed indoors, to avoid installation near the air-conditioner vent, and be away from the heat source.
- The tightening torque shall not exceed 0.2Nm.
- Avoid contact with liquids and corrosive gases.

WIRING SCHEME

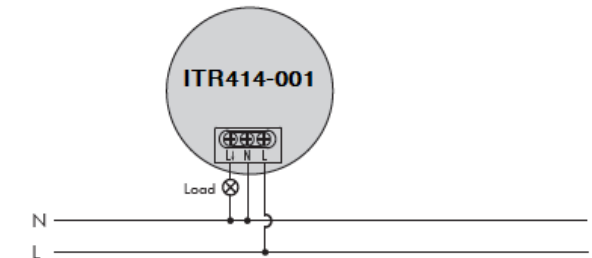

DETECTING

The sensor should be mounted a proper location at max 3 m. The advised mounting height is 2.5m to achieve optimal detection range.

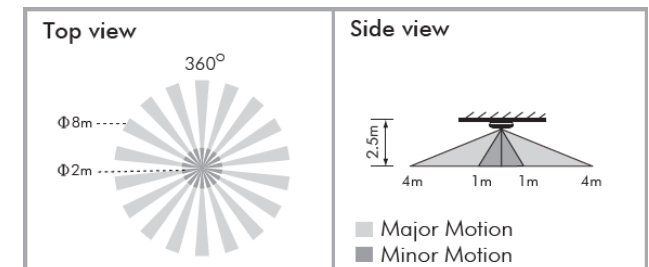

USEFUL INSTALLATION TIPS

As the sensor reacts to temperature changes, the following conditions should be avoided:

- ⚠️ Avoid targeting the sensor toward the objects which may be swayed in the wind, such as curtain, tall plants, miniature garden, etc.
- ⚠️ Avoid targeting the sensor toward the objects whose surfaces are highly reflective, such as mirror, monitor and pool, etc.
- ⚠️ The sensor should be mounted away from heat sources such as air conditioning, lights, vents as dryers, heating vents etc.

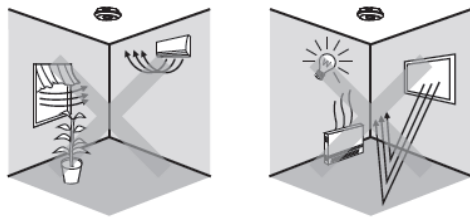

MOUNTING

First, take off the cover with a flat tip screwdriver.

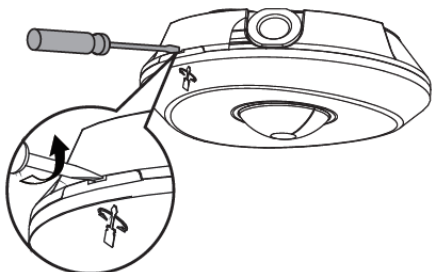

Demount the protection cap of terminals and connect the cables according to the wiring diagram.

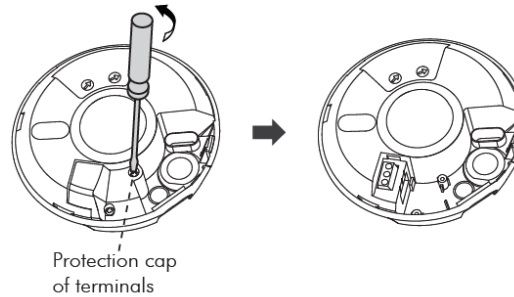

There are two cable entry ways on the bottom case. Choose the desired entry hole and break the knock-out hole and feed the wires through the hole, then fix the wires on the terminal block firmly.

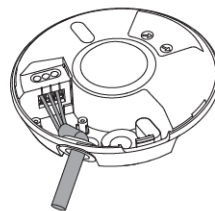

Enter wire through side entry hole

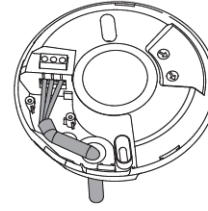

Enter wire through bottom entry hole

There are two mounting holes on the bottom side for fixing the sensor on wall. The distances between two mounting holes are 84 mm maximum and 56 mm minimum. Fix the sensor by 2 screws according to proper distance.

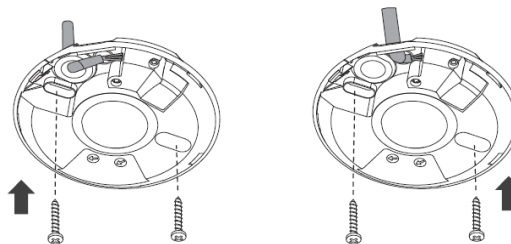

OPERATIONS

Lux, Time Knob

Control Knob	Function	Control Knob Setting
	Set the ambient light value for switching on the load (lighting).	Range: Adjustable from approximately 5 Lux to ∞
	Set delay off time for the load (lighting).	Range: Adjustable from 5 sec to 12 min. Test: Test mode (the load will be 2 sec on, 2 sec off)

Walk Test

The purpose of conducting walk test is to check and adjust the detection coverage. Set Time knob to "Test" for conducting walk test. Lux control is disabled in Test mode.

Test Process

- ⇒ Tester must be within the detection coverage.
- ⇒ Switch power on.
- ⇒ Detector take approx. 60 sec to warm up with load on, then turns off after warming up time.
- ⇒ Walk from outside across to the detection pattern until load turns on for approx. 2sec then off, the next trigger should be 2sec interval.
- ⇒ Adjust lens shield for desired detection range.